

FCC Compliance Statement

FCC ID: ZZNPM100

This device complies with Part 15 of the FCC Rules. Operation is subject to the following two conditions: (1) this device may not cause harmful interference, and (2) this device must accept any interference received, including interference that may cause undesired operation.

The grantee is not responsible for any changes or modifications not expressly approved by the party responsible for compliance. Such modifications could void the user's authority to operate the equipment.

This equipment has been tested and found to comply with the limits for a Class B digital device, pursuant to part 15 of the FCC Rules.

These limits are designed to provide reasonable protection against harmful interference in a residential installation. This equipment generates, uses and can radiate radio frequency energy and, if not installed and used in accordance with the instructions, may cause harmful interference to radio communications.

However, there is no guarantee that interference will not occur in a particular installation. If this equipment does cause harmful interference to radio or television reception, which can be determined by turning the equipment off and on, the user is encouraged to try to correct the interference by one or more of the following measures:

Reorient or relocate the receiving antenna.

Increase the separation between the equipment and the receiver.

Connect the equipment into an outlet on a circuit different from that to which the receiver is connected.

Consult the dealer or an experienced radio/TV technician for help.

Industry Canada (IC) Compliance Statement

IC: 9896A-PM100

This device complies with Industry Canada license-exempt RSS standard(s). Operation is subject to the following two conditions: (1) this device may not cause interference, and (2) this device must accept any interference, including interference that may cause undesired operation of the device. CAN ICES-3(B)/NMB-3(B)

The device meets the exemption from the routine evaluation limits in section 2.5 of RSS 102 and compliance with RSS-102 RF exposure, users can obtain Canadian information on RF exposure and compliance.

This transmitter must not be co-located or operating in conjunction with any other antenna or transmitter. This equipment should be installed and operated with a minimum distance of 20 centimeters between the radiator and your body.

Le présent appareil est conforme aux CNR d'Industrie Canada applicables aux appareils radio exempts de licence. L'exploitation est autorisée aux deux conditions suivantes: (1) l'appareil ne doit pas produire de brouillage, et (2) l'utilisateur de l'appareil doit accepter tout brouillage radioélectrique reçu, même si ce brouillage est susceptible d'en compromettre le fonctionnement du dispositif. CAN ICES-3(B)/NMB-3(B)

Le dispositif rencontre l'exemption des limites courantes d'évaluation dans la section 2.5 de RSS 102 et la conformité à l'exposition et la conformité de rf. Cet émetteur ne doit pas être co-placé ni fonctionnant en même temps qu'aucune autre antenne ou émetteur. Cet équipement devrait être installé et actionné avec une distance minimum de 20 centimètres entre le radiateur et votre corps.



Contact us at
support@4iiii.com

Made in Canada by:



PRECISION

POWER METER

Quick Start Guide

For a complete User Manual go to 4iiii.com/precision

Getting Started!

First ride: Follow all steps. **Next rides:** Wake up, Zero and Ride.

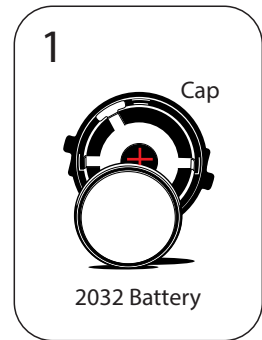

Load Battery into Cap

Ensure that battery, o-ring and cap lid are functional and secure!

These pieces are critical to giving you a water and dust tight seal and must be firmly in place!

Positive side faces into the cap. Attach the cap to your PRECISION pod.

Reinstall

crank and pedals on your bike and tighten to specs

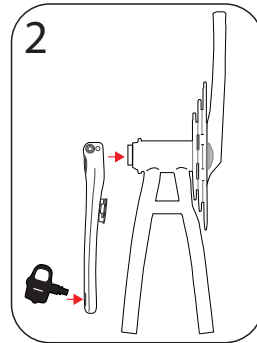

Wake-up

PRECISION by rotating the crank a few times

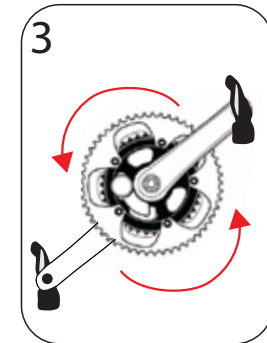

Pair PRECISION

with power-capable devices



Ride

1-4 minutes to warm up PRECISION

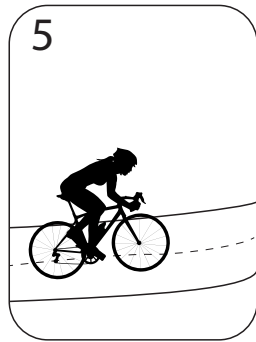

For best results avoid temperature swings between steps 5 and 6

Zero

PRECISION using paired device.
Unclip pedals and position crank arms.
(as shown below)

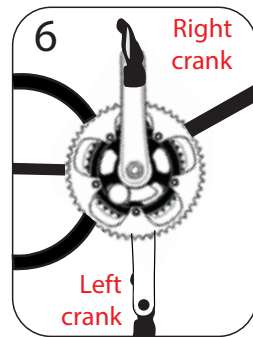

Press "zero offset" or "calibrate" on your display

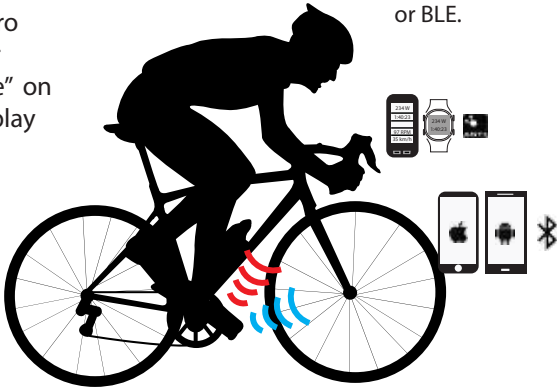

Ride With PRECISION

Data is automatically pushed to your paired device through ANT+ or BLE.

Upload Data from Device



View post-ride performance analysis using your favorite app.

Ride with Heart Rate

Viiiiva Chest Strap Heart Rate Monitor also bridges ANT+ to Bluetooth Smart. 4iii.com/Viiiiva



Ride in Your Zone

Sportiii Heads-up Display syncs with PRECISION and keeps you on target. 4iii.com/Sportiii

